

Installation Guide

4 1/2" Steel Pipe Swing Hanger (SSS-0095-P)

Part List

Tools



Gloves



Safety Glasses

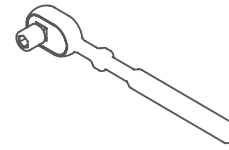

Ratchet

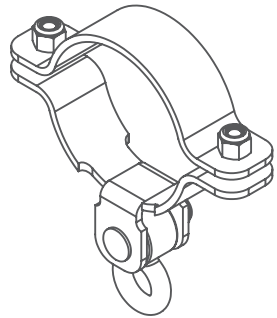

X1

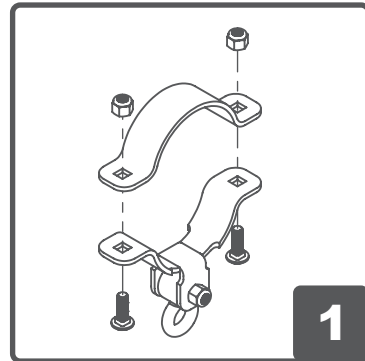

1
Loosen the screws to separate the parts of Swing Hanger.

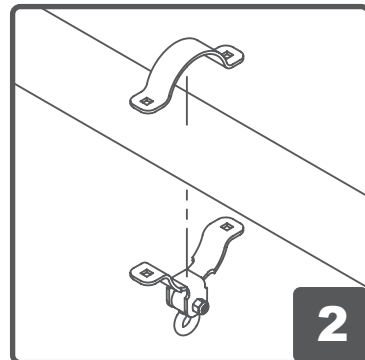

2
Place the top and bottom parts on the pipe.

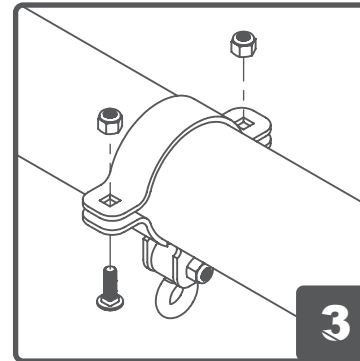

3
Put the screw through the hole and fasten it.

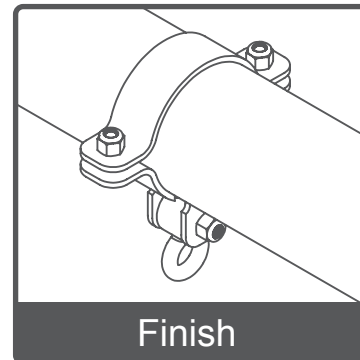

Finish

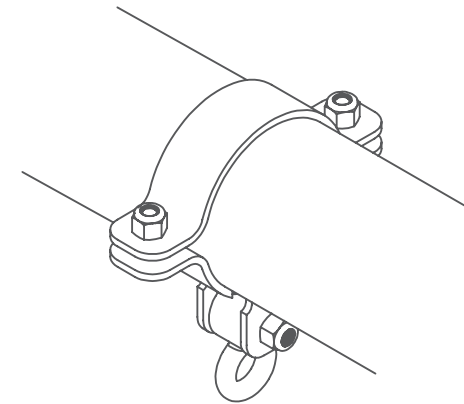

Finish

